

PN6

Schwingungsdämpfer mehrlagig PN6 / Balg 1.4541
Flansch St. 37.2 verzinkt

Amortisseur de vibrations, soufflet en multiparois PN6 / soufflet 1.4541
Bride en acier St. 37.2 zingué

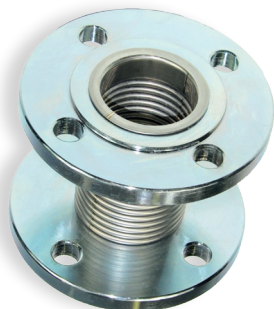

DN	L mm	Lochk. Ø mm	Bohrung	kg	wirksame FK- Fläche cm ² section effective cm ²	Feder- konstante Cx N/mm constante de raideur Cx N/mm	Feder- konstante Cy N/mm constante de raideur Cy N/mm	Art. No.	CHF
40	130	100	4x Ø 14	1.9	23.50	126	21	WAS.845.040.6	252.00
50	130	110	4x Ø 14	2.4	26.50	109	40	WAS.845.050.6	268.00
65	130	130	4x Ø 14	3.0	57.50	81	54	WAS.845.065.6	280.00
80	130	150	4x Ø 18	4.8	78.60	119	127	WAS.845.080.6	313.00
100	130	170	4x Ø 18	5.9	126.80	89	153	WAS.845.100.6	359.00
125	130	200	8x Ø 18	7.5	181.70	115	245	WAS.845.125.6	427.00
150	130	225	8x Ø 18	15.5	266.50	199	668	WAS.845.150.6	492.00
200	130	280	8x Ø 18	17.1	433.40	487	3472	WAS.845.200.6	702.00
250	130	335	12x Ø 18	22.1	699.40	203	2251	WAS.845.250.6	1143.00

PN10

Schwingungsdämpfer mehrlagig PN10 / Balg 1.4541
Flansch St. 37.2 verzinkt

Amortisseur de vibrations, soufflet en multiparois PN10/ soufflet 1.4541
Bride en acier St. 37.2 zingué

DN	L mm	Lochk. Ø mm	Bohrung	kg	wirksame FK- Fläche cm ² section effective cm ²	Feder- konstante Cx N/mm constante de raideur Cx N/mm	Feder- konstante Cy N/mm constante de raideur Cy N/mm	Art. No.	CHF
200	130	295	8x Ø 22	28.0	433.40	487	5516	WAS.845.200.10	****
250	130	350	12x Ø 22	40.0	699.40	750	7483	WAS.845.250.10	****
300	130	400	12x Ø 22	64.0	975.40	789	13447	WAS.845.300.10	****
350	200	460	16x Ø 22	96.0	1087	582	8653	WAS.845.350.10	****
400	200	515	16x Ø 26	112.0	1407	474	7707	WAS.845.400.10	****
450	200	565	20x Ø 26	126.0	1789	587	11842	WAS.845.450.10	****
500	200	620	20x Ø 26	142.0	2190	758	14195	WAS.845.500.10	****

