

Hiddenbed ™

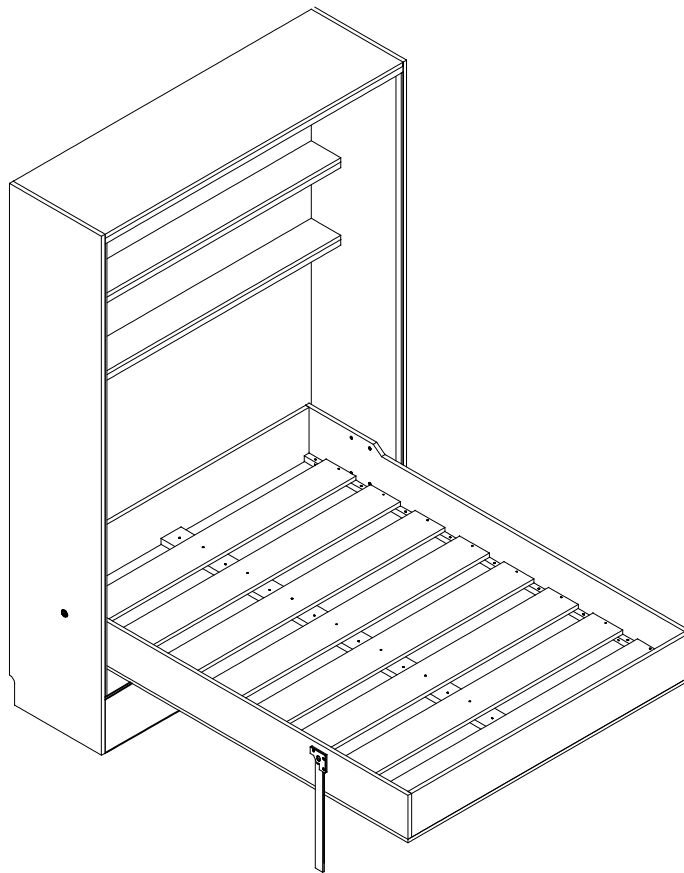
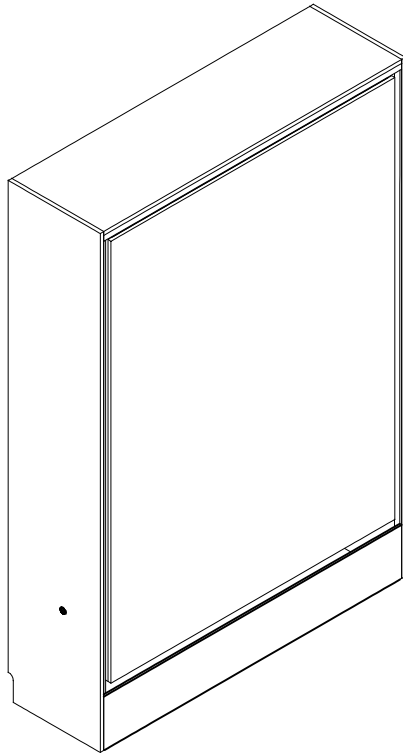

ATTRACTIVE
2000 X 1400

PRODUCTION DRAWINGS - MODEL ATTRACTIVE
TD 117 AT 1400 x 2000 PRU
 All rights reserved.

Important Measurements (unit: millimeters)

Mattress lodge
 Alojamiento colchón

2000 X 1400

**Longitudinal Parts Lenght
 Largo Partes Longitudinales**

Mattress Support Soporte Colchón	1400
Bedrail Thickness 2 x 18 Espesor Largueros	36
Mechanism Clearance Luz para Mecanismo 36 x 2	72
Shelves Estantes	1508
Low Stretcher Separador Inferior	1508

**Drawings Index
 Indice de Planos**

- | | | |
|------------------------------|---|-------------------------------|
| A - Parts List: Body and Bed | / | Lista de Partes: Body and Bed |
| B - Close Position | / | Posición Cerrada |
| C - Bed Position | / | Posición Cama |
| S - Furniture Screws | / | Tornillos para el Mueble |
| M - Mechanism | / | Mecanismo |



Technical drawing suggested.
 They may change according to national safety regulations.
 Manufacturer must assure the correct assembly of all parts.
 Remember! reference for drilling are centers.

Planos sugeridos.
 Pueden cambiar según las normas nacionales de seguridad.
 El fabricante debe asegurar el correcto ensamblaje de las partes.
 Nota! la referencia de las perforaciones es a los centros.

Body Parts List/ Lista de partes

Part N° N° de Pieza	Name Nombre	Qty. Cant.
1	Body Side L/R	2
2	Concealer	2
3	Bottom Stretcher	1
4	Body Top	1
5	Shelf	2
6	Shelf Stretcher	3
7	Bed Stop	2

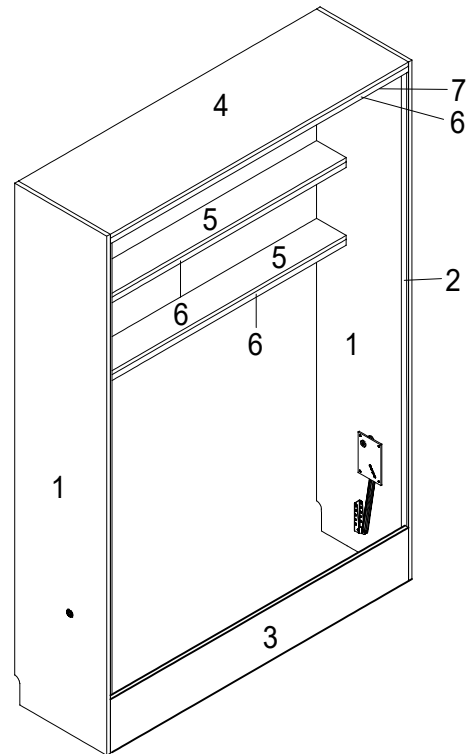

Bed Parts List/ Lista de partes

8	Bed Side	2
9	Bed Left	1
10	Bed Right	1
11	Sides Cleats	2
12	Bed Slats	8
13	Cover	1
14	Side Cleat B	1

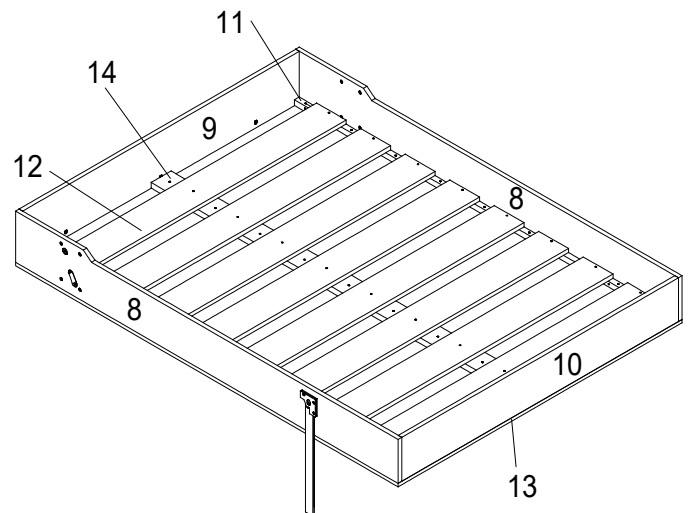

CLOSE POSITION

TD 117 AT 1400 x 2000 PRU

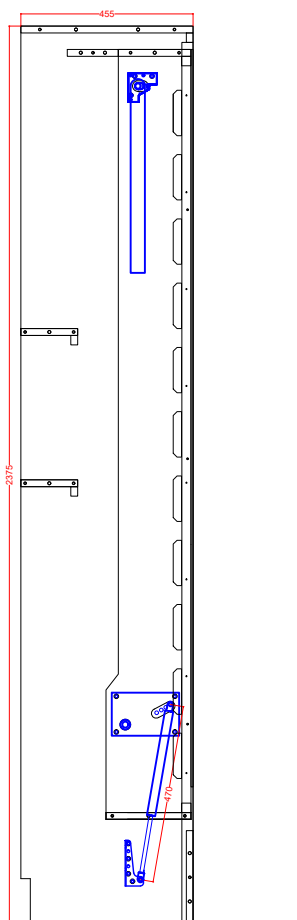
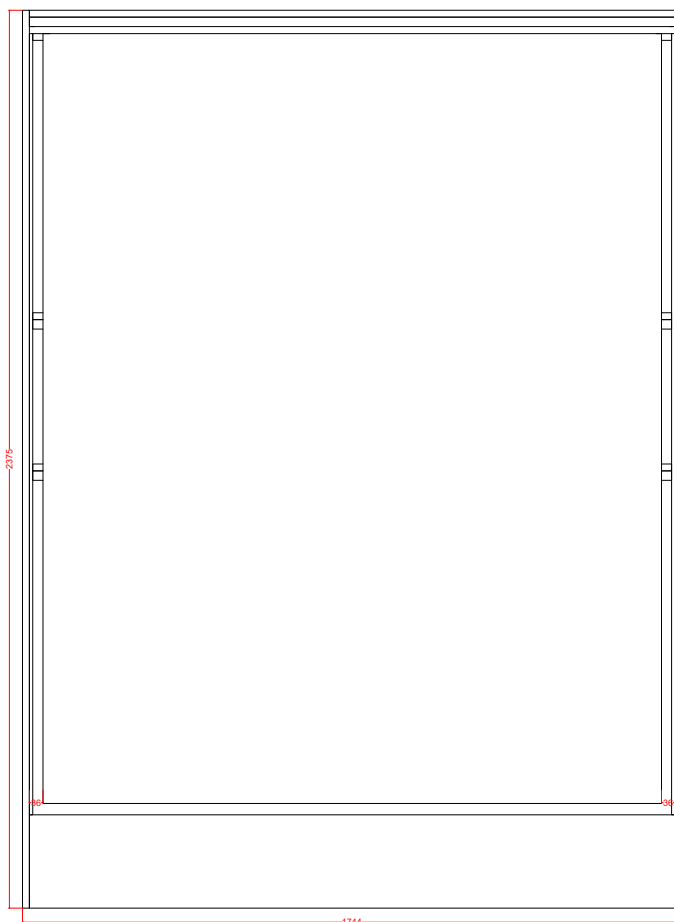

BED POSITION

TD 117 AT 1400 x 2000 PRU

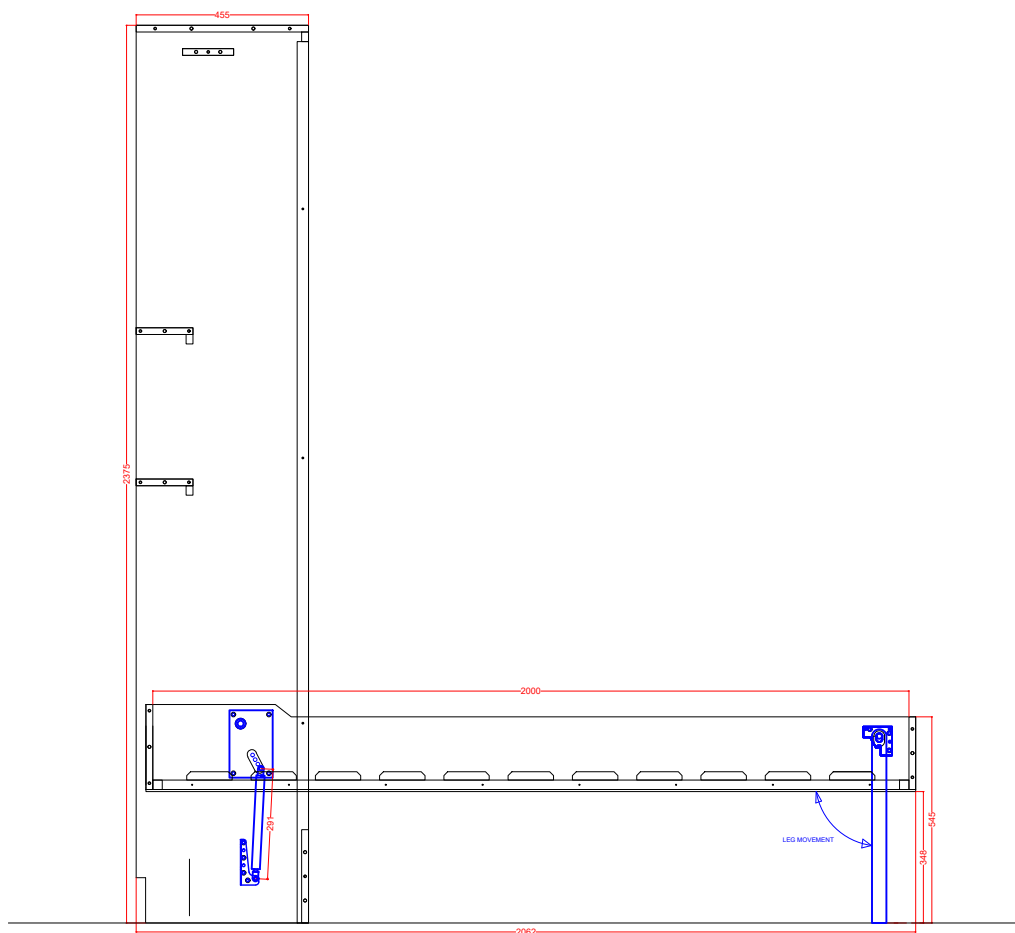
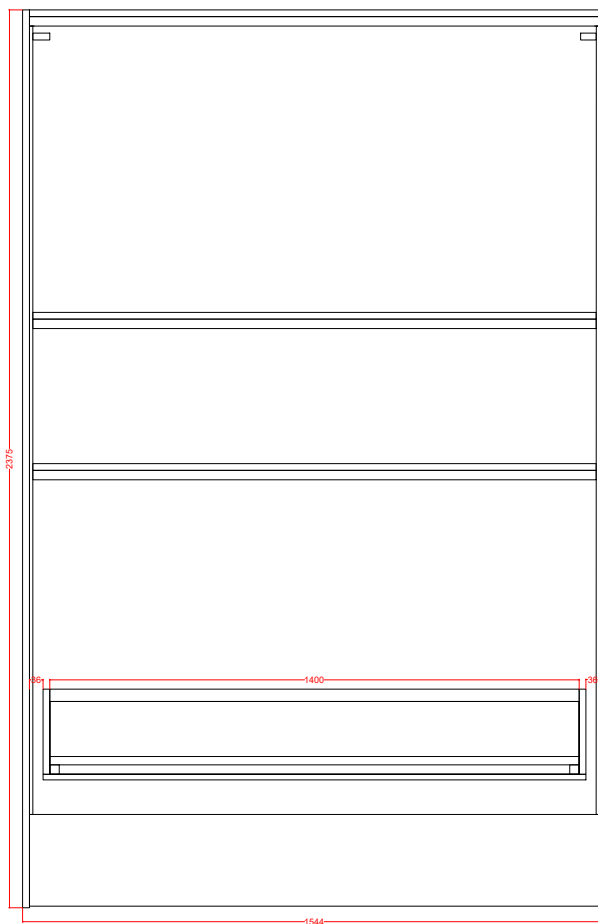

CONFIDENTIAL DRAWINGS
ALL REPRODUCTION PROHIBITED

Hiddenbed  TM PATENTED SYSTEM
© HIDDENBED 2003

DATE
FECHA

17/03/2022

CODE NUMBER
N° DE CÓDIGO

TD 117 AT 1400 x 2000 PRU

PART N°
N° DE PARTE

C

Manufacturer to verify adequate drilling diameter and depth for screw or dowel length in every place.
El fabricante deberá verificar el adecuado diámetro y profundidad de las perforaciones para cada tornillo o tarugo.

+ Drill to drive a screw position

○ Drill for screw through position.

Name	Code	Dimension	Quantity	Sketch
Confirmat	H2	7 x 70	22	
Flat Head Allen & T nut	H11	6 x 15	16	
Screw, Ph Head	H14	4,5 x 35	57	
Round Head Allen & T nut	H12	6 x 30	6	
Dowel 10 x 30 mm		8 x 30	20	
Screw, Ph head	H9	3,5 x 20	6	

Drawing	Screw	Quantity
1	H2 H11 H14	14 8 2
2	H9	6
3		4
4	H14 	5 4
5		4
6	H14	10
7		4
8	H2 H12 H11	8 6 8
9		2
10		2
11	H14	16
12	H14	24
13	----	----
14	----	----
TOTAL		127

Bed Position

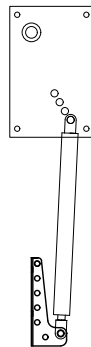

Close Position

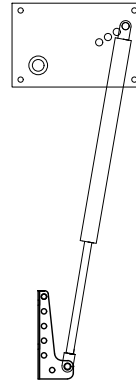

MECHANISM FIXING

S2 SCREWS RESUME:
(INCLUDED IN S1)

Carapaces

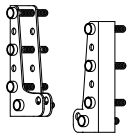

Name	Code	Dimension	Quantity	Sketch
Flat Head Allen & T nut	H11	6 x 15	8	

Mech Plate

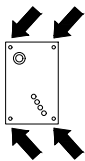

Name	Code	Dimension	Quantity	Sketch
Flat Head Allen & T nut	H11	6 x 15	8	

Leg



Name	Code	Dimension	Quantity	Sketch
Round Head Allen & T nut	H12	6 x 30	6	

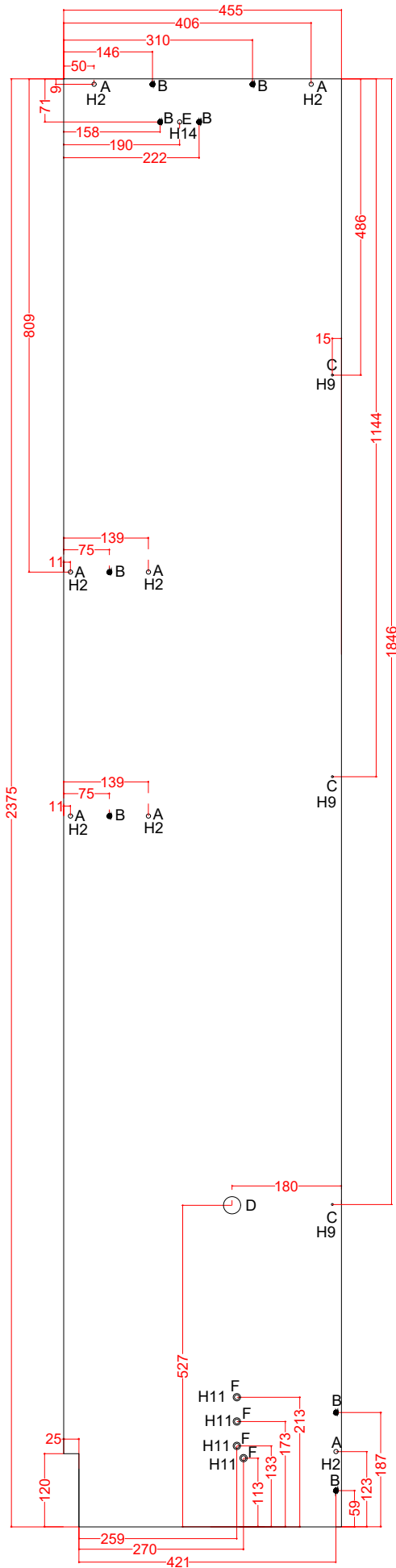
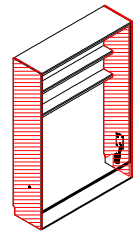

Part: Body Side (1)

Material: MDF

Thick: 18mm

Quantity: 2

SCREW HEADS

H2 7 x 2

H11 4 x 2

H14 1 x 2

PERFORATION

A	7	PASS
B	8	10
C	3	2
D	28	PASS
E	5	PASS
F	8	13
Milling	12	2

Hiddenbed™

PATENTED SYSTEM
© HIDDENBED 2003

CONFIDENTIAL DRAWINGS
ALL REPRODUCTION PROHIBITED

Date: 17/03/2022

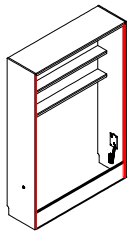

Part: Concealer (2)

Material: MDF

Thick: 9mm

Quantity: 2

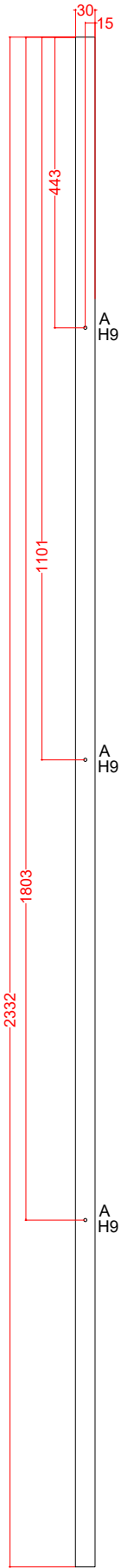

SCREW HEADS

H9	3 x 2
----	-------

PERFORATION

A	5	PASS

Hiddenbed ™
 PATENTED SYSTEM
 © HIDDENBED 2003

CONFIDENTIAL DRAWINGS
 ALL REPRODUCTION PROHIBITED
 Date: 17/03/2022

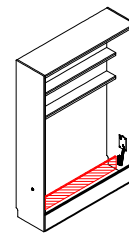

Part: Bottom Stretcher(3)

Material: MDF

Thick: 18 mm

Quantity: 1

SCREW HEADS



4

PERFORATION

A	5.5	70
B	8	22

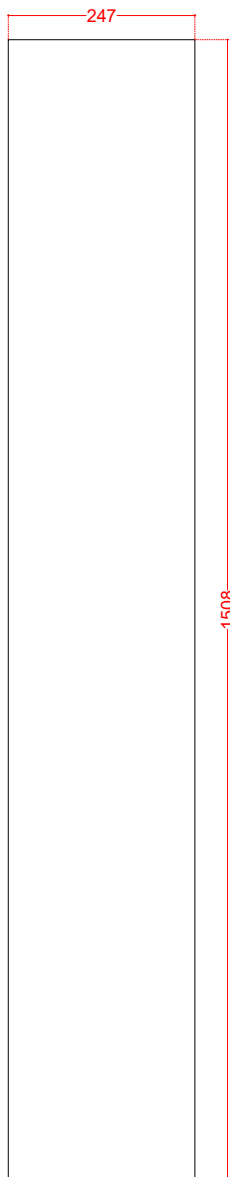

BOTH ENDS
AMBOS EXTREMOS

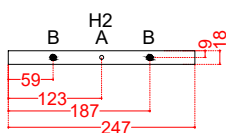

Hiddenbed ™

PATENTED SYSTEM
© HIDDENBED 2003

CONFIDENTIAL DRAWINGS
ALL REPRODUCTION PROHIBITED

Date: 17/03/2022

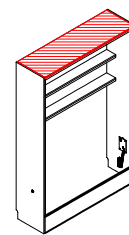

Part: Body Top (4)

Material: MDF

Thick: 18 mm

Quantity: 1

SCREW HEADS

	4
H14	5

PERFORATION

A	5.5	70
B	8	22
C	5	PASS

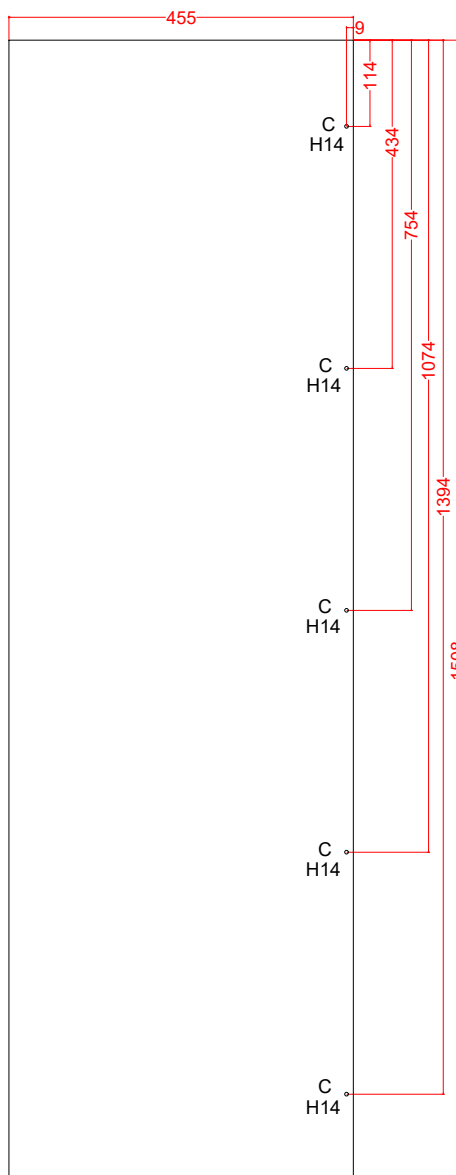

BOTH ENDS
AMBOS EXTREMOS

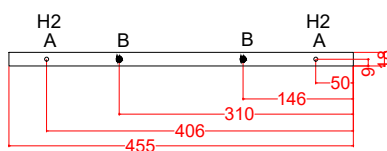

Hiddenbed 

PATENTED SYSTEM
© HIDDENBED 2003

CONFIDENTIAL DRAWINGS
ALL REPRODUCTION PROHIBITED

Date: 17/03/2022

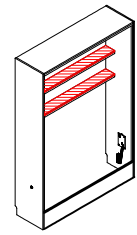

Part: Shelf (5)

Material: MDF

Thick: 18 mm

Quantity: 2

SCREW HEADS



2 x 2

PERFORATION

A	5.5	70
B	8	22
C	3	2

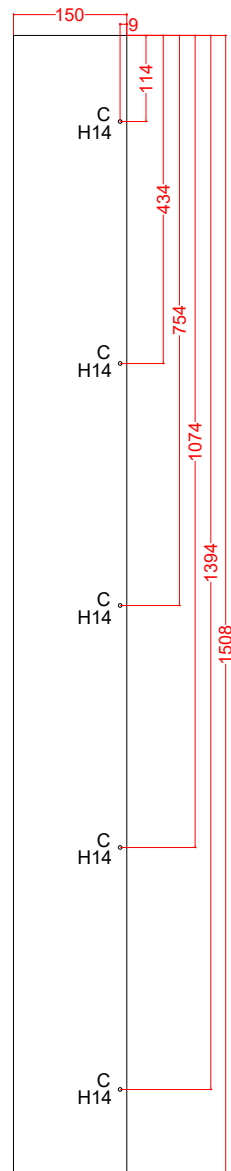

**BOTH ENDS
AMBOS EXTREMOS**

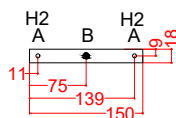

Hiddenbed™

PATENTED SYSTEM
© HIDDENBED 2003

CONFIDENTIAL DRAWINGS
ALL REPRODUCTION PROHIBITED

Date: 17/03/2022

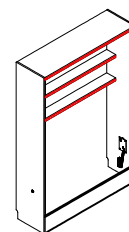

Part: Shelf Stretcher(6)

Material: MDF

Thick: 18 mm

Quantity: 2A + 1B

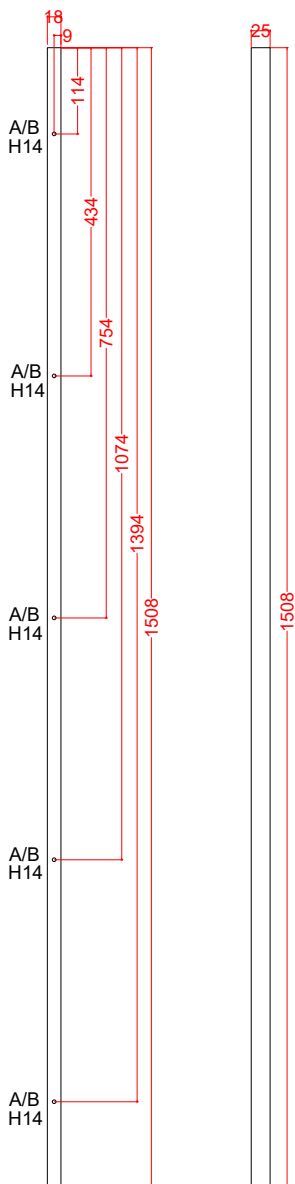

A perforations are for one stretcher
Stretcher for body top is screwed downwards



B perforations are for two other stretchers
which need to be screwed on this piece
Stretchers for Shelves are screwed upwards



SCREW HEADS

H14 5 x 2

PERFORATION

A	3	2
B	5	PASS



CONFIDENTIAL DRAWINGS
ALL REPRODUCTION PROHIBITED

Date: 17/03/2022

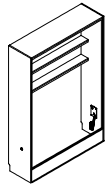

Part: Bed Stop (7)

Material: MDF

Thick: 18 mm

Quantity: 2

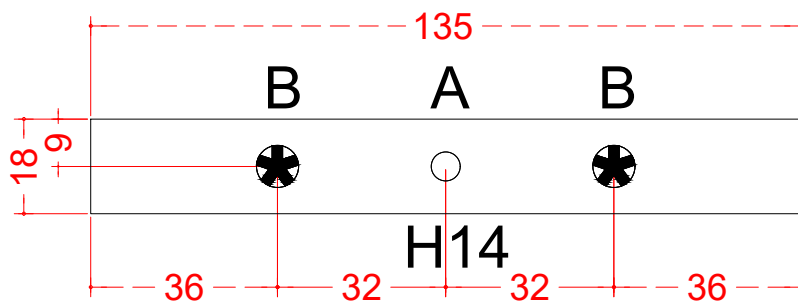

SCREW HEADS



2 x 2

PERFORATION

A	3	2
B	8	22

Hiddenbed™
 PATENTED SYSTEM
 © HIDDENBED 2003

CONFIDENTIAL DRAWINGS
 ALL REPRODUCTION PROHIBITED

Date: 17/03/2022

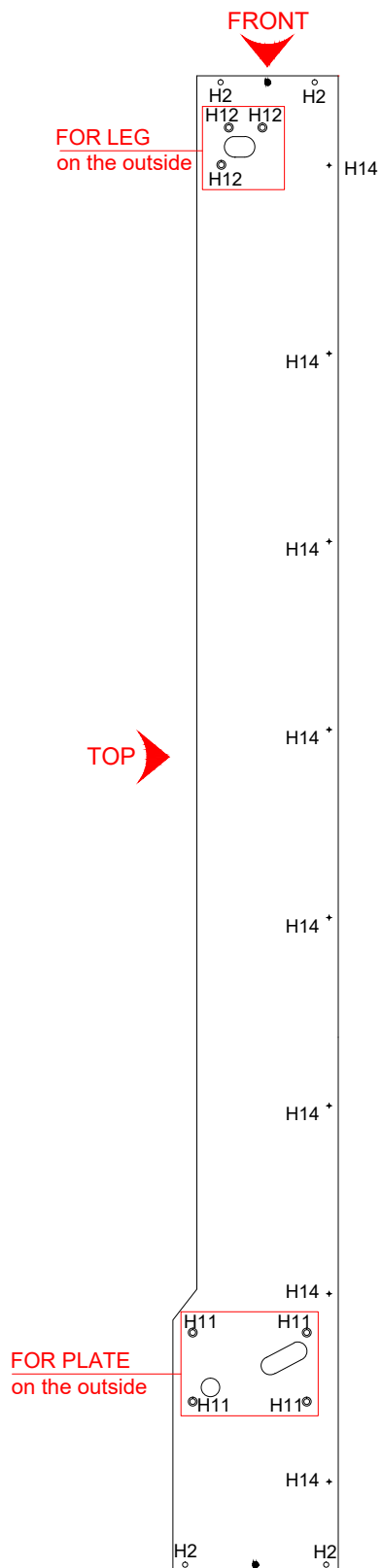
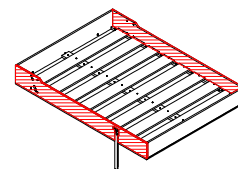

Part: Bed Side (8)

Material: MDF

Thick: 18 mm

Quantity: 2

SCREW HEADS

H2	4 x 2
H12	3 x 2
H11	4 x 2

PERFORATION

Hiddenbed™

PATENTED SYSTEM
© HIDDENBED 2003

CONFIDENTIAL DRAWINGS
ALL REPRODUCTION PROHIBITED

Date: 17/03/2022

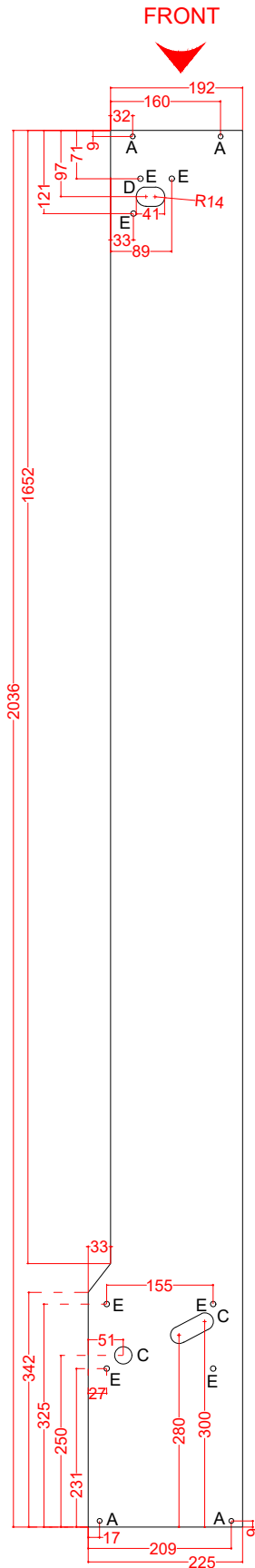
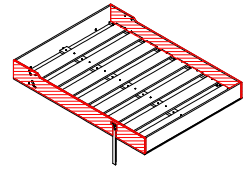

OUTSIDE VIEW
VISTA EXTERIOR

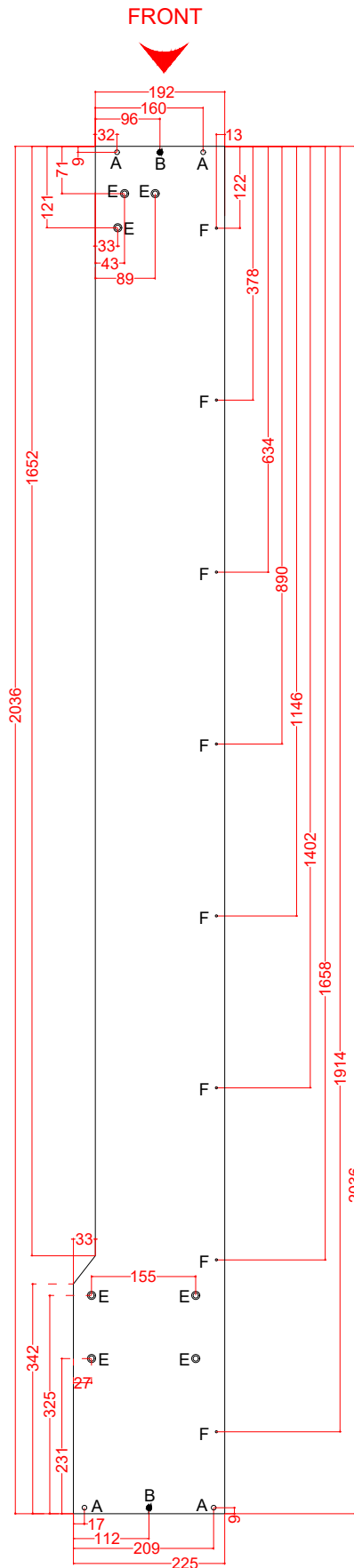

INSIDE VIEW
VISTA INTERIOR

Part: Bed Side (8)
Material: MDF
Thick: 18 mm
Quantity: 2

SCREW HEADS

PERFORATION

A	7	PASS
B	8	10
C	25	12
D	28	5
E	8	PASS
Milling	12	2
F	3	2

Hiddenbed  TM
PATENTED SYSTEM
© HIDDENBED 2003

CONFIDENTIAL DRAWINGS
ALL REPRODUCTION PROHIBITED

Date: 17/03/2022

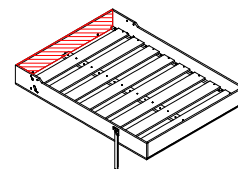

Part: Bed Left (9)

Material: MDF

Thick: 18 mm

Quantity: 1

SCREW HEADS

	2
---	---

PERFORATION

A	5.5	70
B	8	22

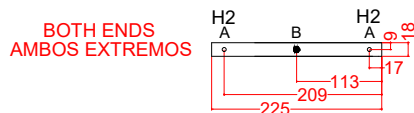
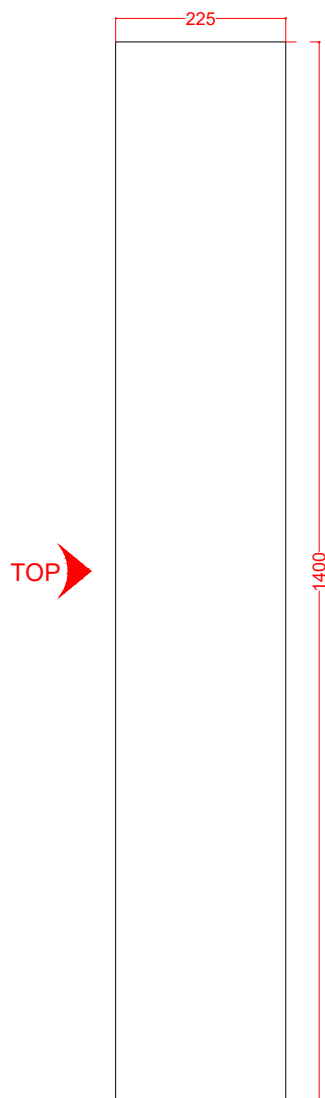

Hiddenbed 

PATENTED SYSTEM
© HIDDENBED 2003

CONFIDENTIAL DRAWINGS
ALL REPRODUCTION PROHIBITED

Date: 17/03/2022

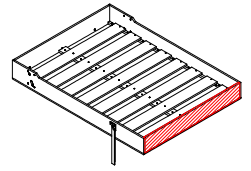

Part: Bed Right (10)

Material: MDF

Thick: 18 mm

Quantity: 1

SCREW HEADS



2

PERFORATION

A	5.5	70
B	8	22

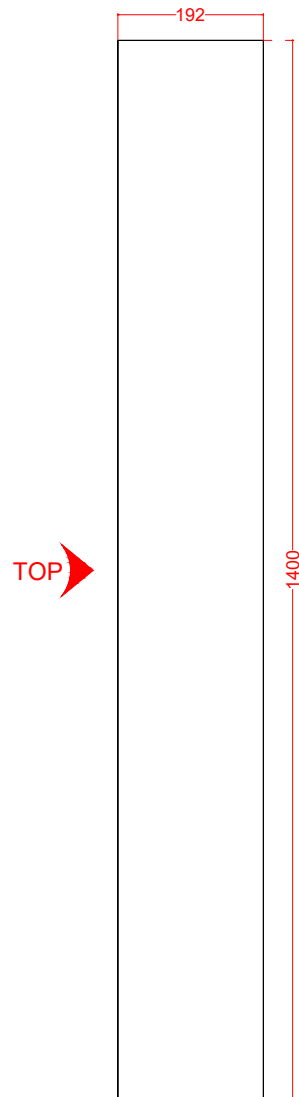

BOTH ENDS
AMBOS EXTREMOS

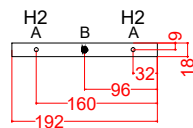

Hiddenbed™

PATENTED SYSTEM
© HIDDENBED 2003

CONFIDENTIAL DRAWINGS
ALL REPRODUCTION PROHIBITED

Date: 17/03/2022

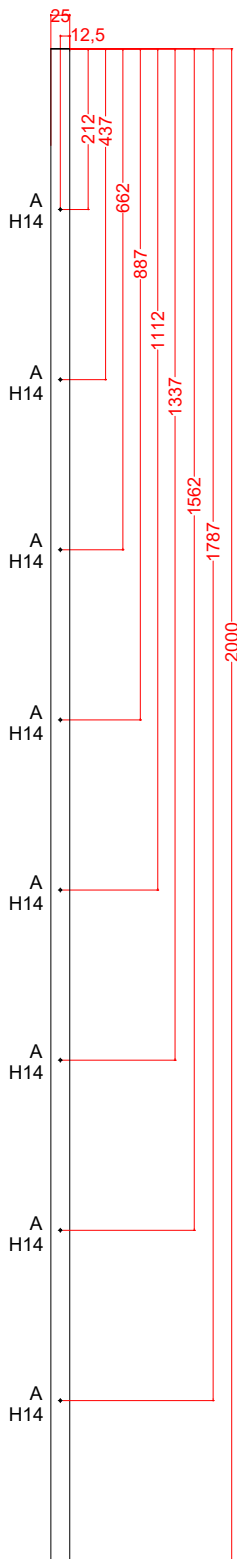
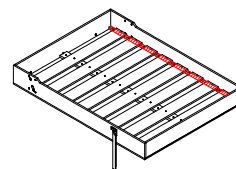

ARRIBA
TOP

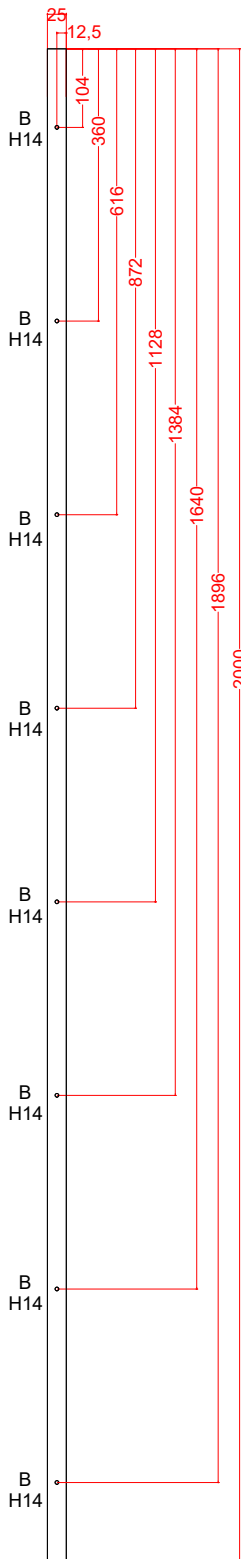

LATERAL
SIDE

Part: Slats Cleats (11)

Material: MDF

Thick: 25 mm

Quantity: 2

SCREW HEADS

H14 8 x 2

PERFORATION

A	3	2
B	5	PASS

Hiddenbed  TM

PATENTED SYSTEM
© HIDDENBED 2003

CONFIDENTIAL DRAWINGS
ALL REPRODUCTION PROHIBITED

Date: 17/03/2022

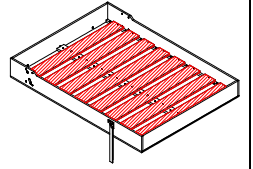

Part: Bed Slats (12)

Material: MDF

Thick: 18 mm

Quantity: 8

SCREW HEADS

H14	3 x 8
-----	-------

PERFORATION

A	5	PASS
---	---	------

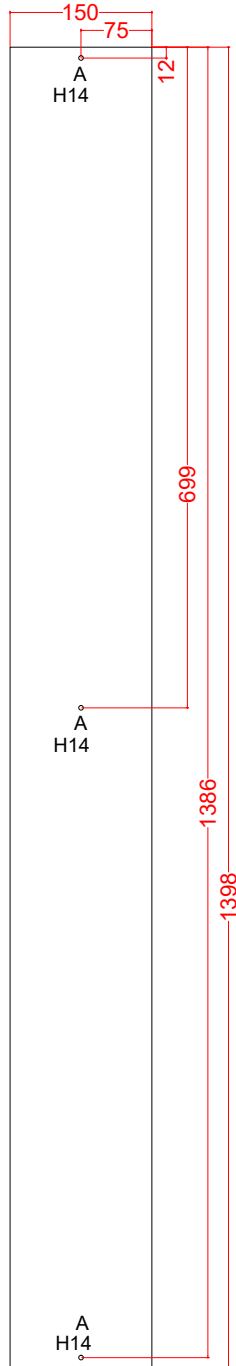

Hiddenbed ™

PATENTED SYSTEM
© HIDDENBED 2003

CONFIDENTIAL DRAWINGS
ALL REPRODUCTION PROHIBITED

Date: 17/03/2022

TD 117 AT 1400 x 2000 PRU

1400 - 2000

TD 117 AT 1400 x 2000 PRU

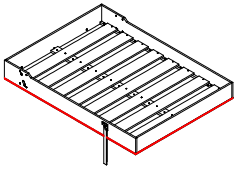

Part: Cover (13)

Material: MDF

Thick: 5,5 mm

Quantity: 1

SCREW HEADS

PERFORATION

Hiddenbed 

PATENTED SYSTEM
© HIDDENBED 2003

CONFIDENTIAL DRAWINGS
ALL REPRODUCTION PROHIBITED

Date: 17/03/2022

TD 117 AT 1400 x 2000 PRU

1400 - 2000

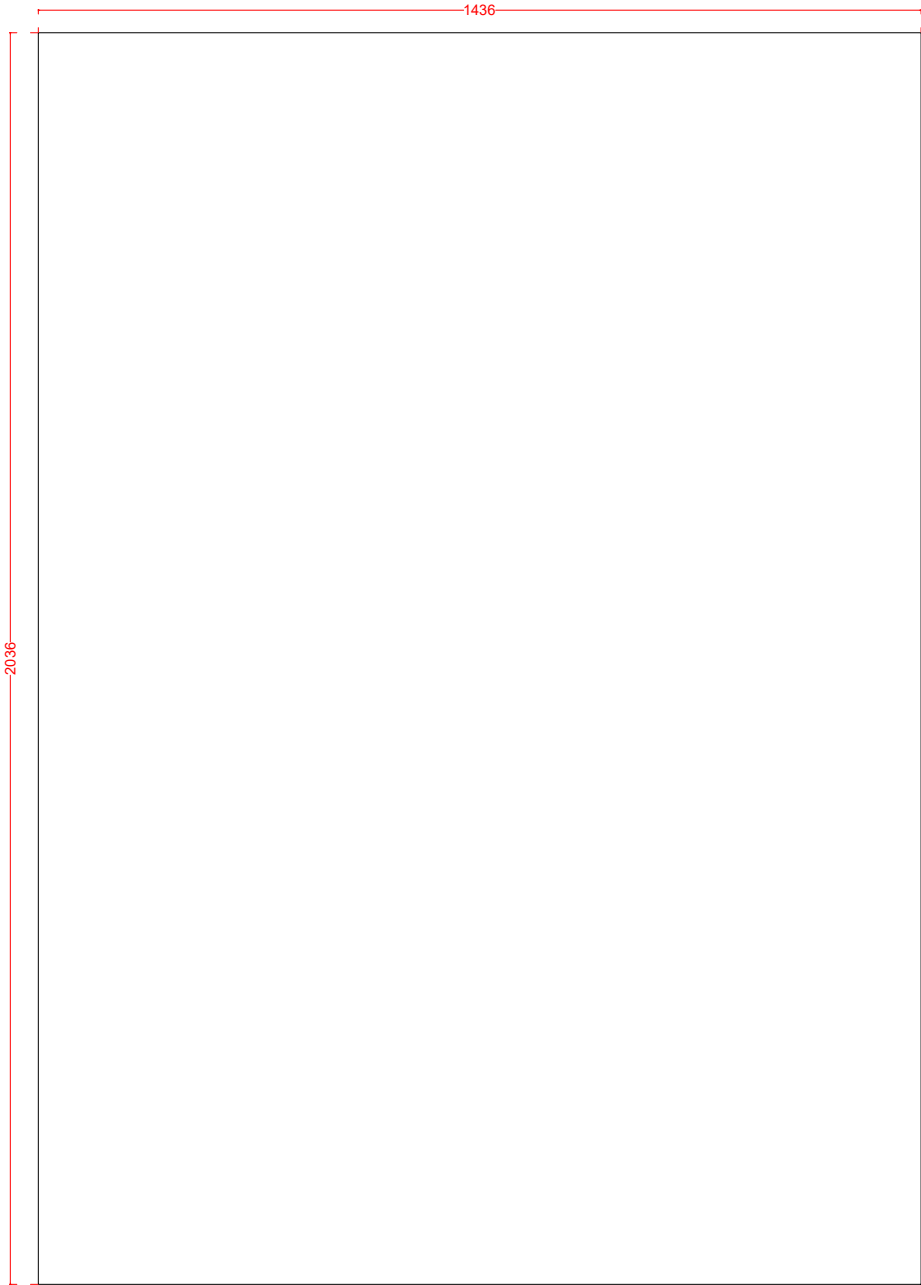

TD 117 AT 1400 x 2000 PRU

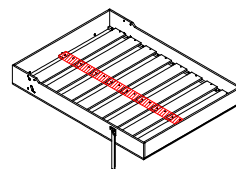

Part:Slat Cleats B (14)

Material: MDF

Thick: 25 mm

Quantity: 1

SCREW HEADS

PERFORATION

A	3	2

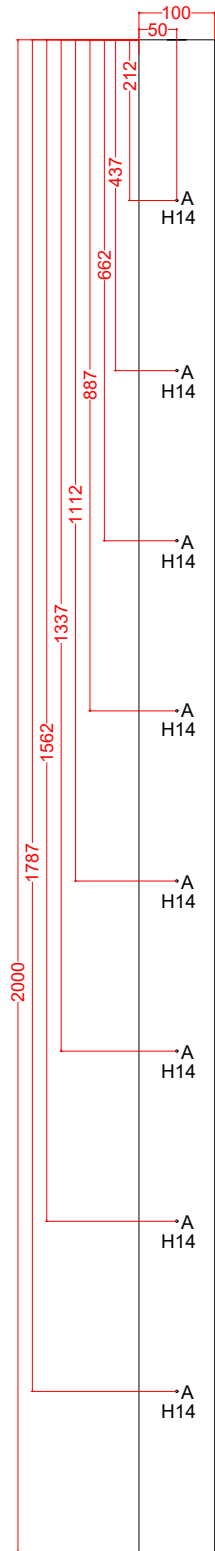

Hiddenbed ™
PATENTED SYSTEM
© HIDDENBED 2003

CONFIDENTIAL DRAWINGS
ALL REPRODUCTION PROHIBITED

Date: 17/03/2022

TD 117 AT 1400 x 2000 PRU

MANUFACTURING DATA
FICHA FABRICACIÓN

DATE FECHA	COMPANY NAME EMPRESA
CITY CIUDAD	COMPANY CONTACT CONTACTO FABRICA
ADDRESS DIRECCION	EMAIL
TEL	RESPONSABLE R&D

PICTURES
IMAGENES